

Alcatel **Mobile Reflexes™**

Alcatel OmniPCX 4400

OK



ALCATEL

ARCHITECTS OF AN INTERNET WORLD

Precautions for use

This approved DECT telephone is intended to be used with an ALCATEL cordless PABX.

The following conditions of use must be respected, particularly as regards the use of radioelectric frequencies:

- DECT equipment can only be used to establish links between fixed points if these links are temporary and the equivalent isotropically radiated power at the antenna is less than 250 mW.
- The conditions of access to a DECT equipment telepoint network shall be stipulated by contract with the operator of the authorized telepoint network concerned.

This telephone is specially designed for use with an Alcatel OmniPCX 4400 system as described in the guide.

Do not expose your telephone to severe conditions (rain, sea air, dust, etc.).

Correct operation of your telephone is not guaranteed in temperatures outside the range -10 °C to +45 °C.

You must not switch on or use your telephone near gas or inflammable liquids.

You have just acquired a **Mobile 100** or **200** and we thank you for making this choice: it is a reliable telephone designed to make life easier for you.

Contents

Precautions for use

Your telephone	p. 4
-----------------------------	-------------

1.	Display and corresponding icons	p. 5
	1.1 Status icons	p. 5
	1.2 MENU icons	p. 6
	1.3 Call icons	p. 7
	1.4 How to read this guide	p. 8

2.	Getting started	p. 9
	2.1 Charging the telephone	p. 9
	2.2 Switching on your telephone	p. 10
	2.3 Accessing the MENU and navigating	p. 10

3.	Using your telephone	p. 11
	3.1 Making a call	p. 11
	3.2 Answering a call	p. 11
	3.3 Calling from your personal directory	p. 12
	3.4 Calling your correspondent by name	p. 12
	3.5 Calling back one of the last 6 numbers dialled (Redial)	p. 13
	3.6 Making a call-back request	p. 13

4.	Handling several calls	p. 14
	4.1 Calling a second correspondent (enquiry call)	p. 14
	4.2 Answering a second call	p. 14
	4.3 Switching between calls (broker call)	p. 14
	4.4 Transferring a call	p. 15

5.	While you are away - When you return	p. 16
	5.1 Forwarding your calls to another number (immediate forward)	p. 16
	5.2 Forwarding your calls to the voice mail	p. 17
	5.3 Cancelling all forwards	p. 17
	5.4 Making another type of forward	p. 18
	5.5 Consulting the messages left while you were away ..	p. 19

6.	Customizing your telephone	p. 21
	6.1 Programming your password	p. 21
	6.2 Creating a sheet in your personal directory	p. 22
	6.2 Activating the vibrator or ringer (Mobile 200)	p. 23
	6.3 Customizing the ringer	p. 23
	6.4 Selecting the language	p. 24

7.	Accessories	p. 25
-----------	--------------------------	--------------

Warranty	p. 27
-----------------------	--------------

Your telephone

Headphone connector

Light indicating :

- Going out of radio coverage (fast flashing)
- New message (slow flashing)
 - green: Mobile 100
 - red: Mobile 200

Adjust audio volume

Access to the MENU
Navigate
Confirm

Off-hook
Redial (long press)
Switching between calls (during enquiry call)

Activate/deactivate loudspeaker
Activate the secret on hands-free charger

Erase a character
Display previous menu
Erase complete field (long press)

Hang up
Return to idle
Lock/unlock the keypad (long press)

Activate / deactivate vibrator* (long press)

Phone book

Microphone

On / Off (long press)
Access to the On/Off menu (1st press) to switch off the telephone, activate/disable the vibrator, activate/disable the ringer, lock the keypad

* depending on your model of telephone









For further information, visit our web site www.alcatel.com

1. Display and corresponding icons

The display features 1 line of status icons and 3 lines of 16 alphanumerical characters. The Mobile 200 also features a display and backlit keypad.

1. Status icons

The status icons are displayed on the welcome screen and indicate the status of the telephone.

-  **Battery charge level**
-  **Messages received:**
voice and text messages, call-back requests and unanswered calls
-  **Calls received that have remained unanswered** (if no other types of message)
-  **Forward activated**
-  **Ringer active**
-  **Vibrator active** (Mobile 200)
-  **Ringer disabled**
-  **Programmed call-back time**
-  **Radio reception quality**

You can obtain details on the status icons from the tooltips that appear on the welcome screen when you use the navigator:

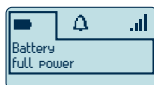

Press the  key to make these tooltips disappear.

The MENU is accessible from the welcome screen by pressing the navigation key 

It provides access to all the functions available on your system.

**Directories:**

manage your personal directory and access the phone book.

**Redial:**

call back one of the last 6 numbers dialled.

**Forwarding:**

forward your calls to another number.

**Mail:**

consult the messages and send voice and text messages.

**Manager/secretary*****Supervision*****Adjustment:**

adjust contrast, activate or deactivate the beeps, lighting, etc.

**Guide:**

programming, function list, etc.

**Selecting the language**



Adjusting the ringer



Appointment:

program a call-back time



System lock:

prohibit outgoing calls and modification of the programming



System selection



Installation (installation reserved)

* These icons are only proposed if the corresponding functions are installed.

1

3. Call icons



Making a call



Answering a call*



In conversation*



Call on hold*



Accessing the directories



Transferring a call



Switching to DTMF signals



Setting up a conference



Additional options



Call duration

* In the event of a multiple call, the icons are given indices to represent the different correspondents.



Press briefly on the navigation key to access the MENU and to confirm.



Move the navigation key up or down.



Move the navigation key to the left or right.



Use the keypad to enter digits and letters.



Important information.

These symbols can be supplemented by small icons or texts.

All default or customized function codes are given in the table of codes supplied with the telephone.

The functions described in this guide only concern telephones programmed in multiline mode which is the default configuration when the mobile is installed.

2. Getting started

2 1. Charging the telephone

• Installing the battery:



Position the battery in the slide following the mark on the label



Slide it until it clicks into place



• Charging the battery:



Connect the charger and place the telephone in the charging holder

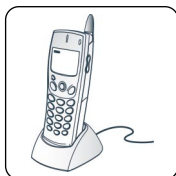

The battery is charged*. The light is on and the battery icon is displayed.

Recharge your telephone battery regularly. The telephone can be on or off when recharging the battery.

If the telephone is to remain unused or out of its charger for several weeks, remove the battery and store it separately.

The **Mobile 100** functions exclusively with the Ni-Mh battery, and the **Mobile 200** with the Li-Ion battery.

* battery charged after 3h or 5h depending on the model.

2 2. Switching on your telephone



Switch on
(long press)

Wait a moment (about
3 seconds)

Your telephone
is switched on

• Switching off your telephone:

Press the  key (long press).

2 3. Accessing the MENU and navigating

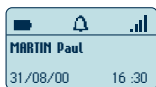

Welcome screen

Confirm

Main menu

• Accessing the functions:

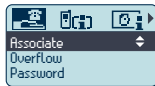

Select a function in the
MENU

Confirm

Within the function you can
move horizontally along the
different icons or vertically in
the text menus

3. Using your telephone

3 1. Making a call

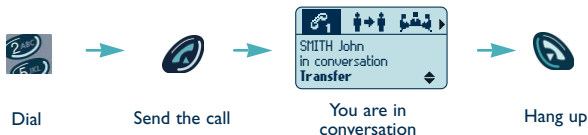

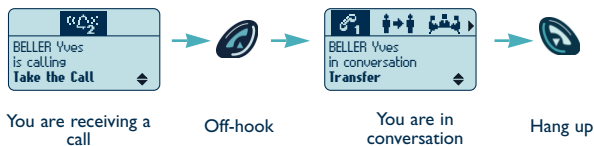

To make an external call, dial the outside line access code before your correspondent's number.

3 2. Answering a call



The ringer does not ring if:

- the vibrator is active and the ringer is disabled, the  icon is displayed on the welcome screen,
- the ringer is disabled and the  icon is displayed on the welcome screen.

The light flashes if both the ringer and the vibrator are disabled.

3. Calling from your personal directory

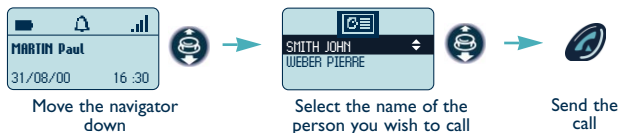

You can also activate your directory by using the **"Personal Dir"** option of the function.

4. Calling your correspondent by name

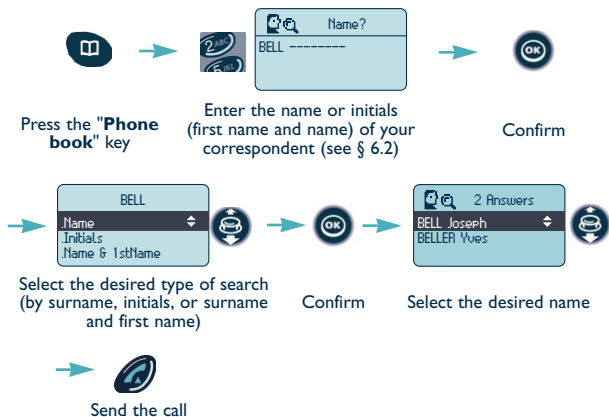

You can also activate your directory by using the **"Phone Book"** option of the function.

3 5. Calling back one of the last 6 numbers dialled (Redial)

To call back the last number dialled press  (long press).

Or else

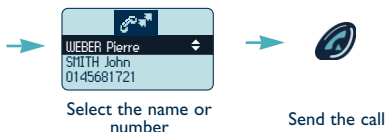

3 6. Making a call-back request

When your correspondent's number does not reply or is busy:

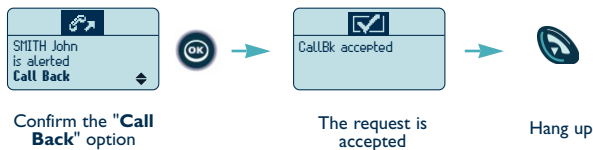

4. Handling several calls

Certain functions can be activated either by using the text menu or by selecting an icon in the icon strip with the navigator.

4 1. Calling a second correspondent (enquiry call)



Dial the number

Send the call



The first correspondent is placed on hold

Hang up to cancel the enquiry call

Off-hook to retrieve the first correspondent

4 2. Answering a second call

During a call, a second correspondent tries to contact you:

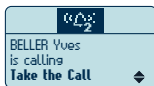

A second call comes in and is indicated by a series of beeps

Off-hook

The first correspondent is automatically placed on hold

4 3. Switching between calls (broker call)

To switch from one correspondent to the other:



4 4. Transferring a call

You are holding a conversation. Make an enquiry call to contact the transfer destination number, then:

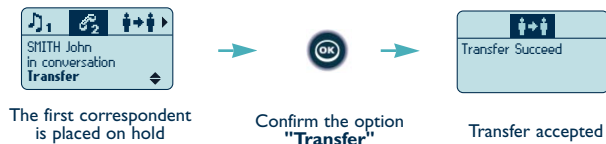

5. While you are away - When you return

5 1. Forwarding your calls to another number (immediate forward)

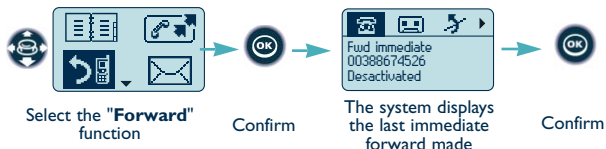

To activate forward to the same number

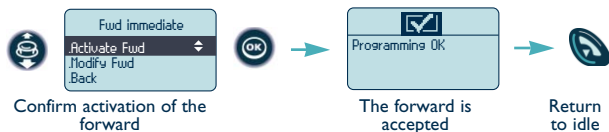

To change the forward destination number

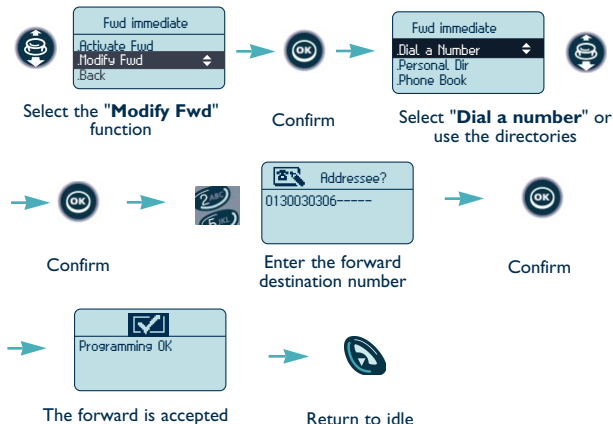

5 2. Forwarding your calls to the voice mail

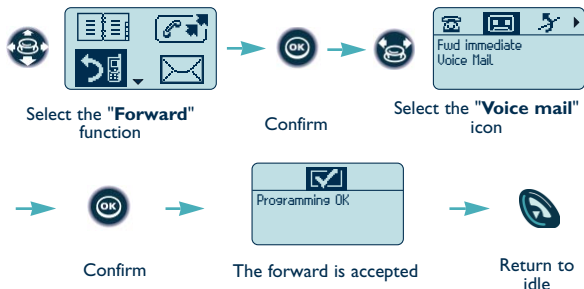

5 3. Cancelling all forwards

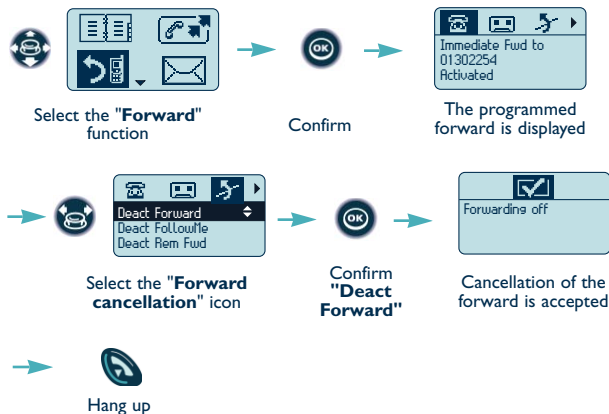

5 4. Making another type of forward

You can program call forward on busy, on no reply, etc.

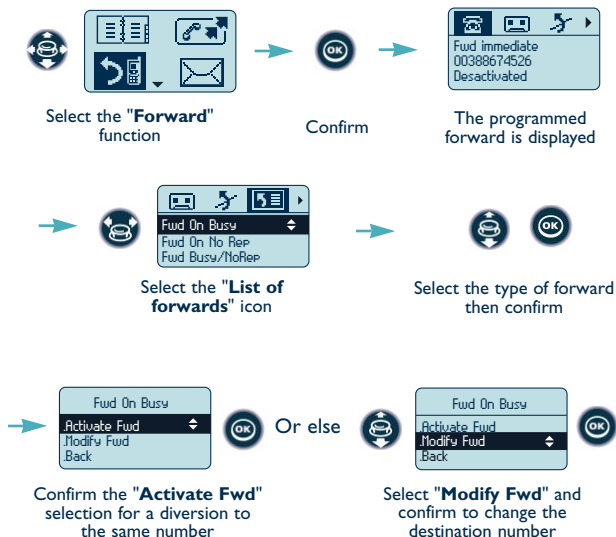

5. Consulting the messages left while you were away

You can consult the messages left while you were away: voice messages, call-back requests, text messages, list of internal and external calls.

• Voice messages

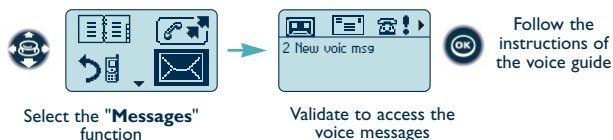

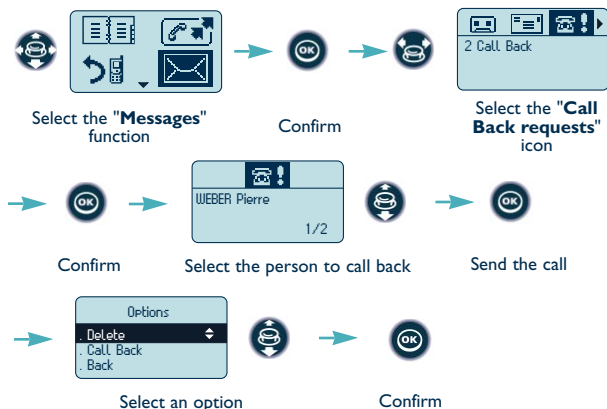

• Call-back requests



If you use the **"Call Back"** option, the request is deleted even if your call is not answered. Otherwise the request is stored until the **"Delete"** option is selected.

- **Lists of unanswered internal or external calls**

The procedure for consulting the lists of unanswered internal or external calls is identical to that for the call-back requests. To access them, select the  ^{int} (internal) or  ^{ext} (external) icons.

- **Messages textes**

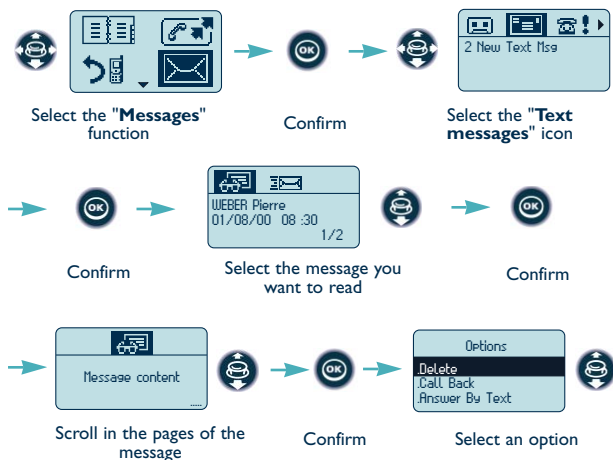

If you use the **"Call Back"** option, the message is deleted if your call is answered. Otherwise the request is stored until the **"Delete"** option is selected.

6. Customizing your telephone

6 1. Programming your password

You will need to enter your password to activate certain functions:

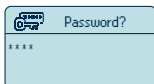

Enter your password
The default code is 0000

Confirm

• Modifying your password

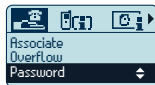

Select the **"Guide"**
function

Confirm

Select the **"Password"**
option

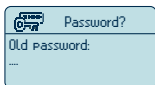

Confirm

Enter your password or the default
code 0000

Confirm

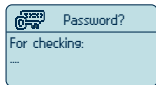

Enter the new password:
4 figures

Confirm

Confirm the new password

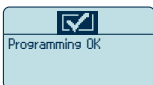

Confirm

Return to idle

6 2. Creating a sheet in your personal directory

Your personal directory can contain up to 12 numbers.

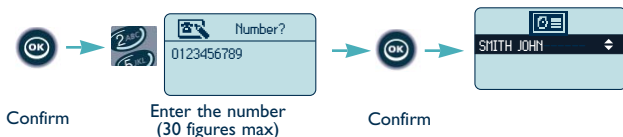

(*) To enter the name: the keys of the numerical keypad have letters that can be displayed by pressing the key the appropriate number of times in succession. A grid at the base of the display indicates the selected character.
Example: press "8" two times in succession to display the letter "U".

In case of error, use the  key to delete.

6 3. Activating the vibrator or ringer (Mobile 200)

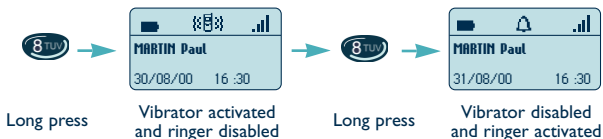



This key can be used to switch rapidly from the ringer to the vibrator and vice-versa.

6 4. Customizing the ringer

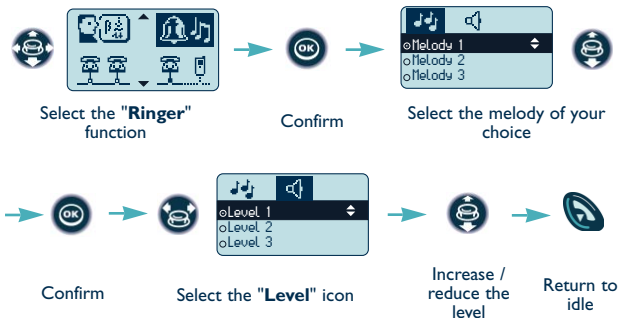
• Choosing the melody and volume



• Rapid customizing of the ringer

Depending on your activity, the ringer parameters can be modified rapidly by a short press on the  key and then using the  key.

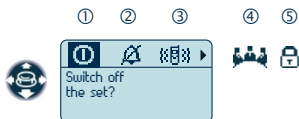

- ① Switch off the telephone
- ② Activate / disable the vibrator (Mobile 200)
- ③  Activate / disable the ringer
- ④ Activate / disable meeting mode (progressive ringing)
- ⑤ Activate the keyboard lock

Validate  the chosen option.

6 5. Selecting the language

You can select the language used in your telephone displays and voice guides.

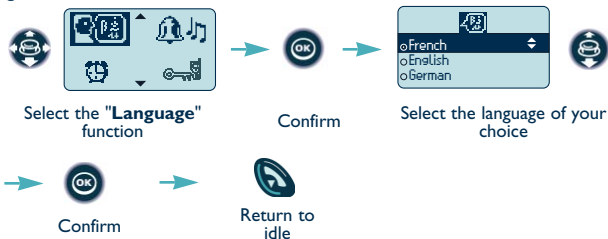

7. Accessories

Chargers

Several models of charger are available.



The "**Corded**" simple charger.



The "**Basic Desktop**" mini office charger.



The "**Dual Desktop**" office charger with extra battery recess.



The "**Voice Desktop**" hands-free office charger.

- **Battery charging time:**

Mobile 100: ~ 5 h 00

Mobile 200: ~ 3 h 00

Additional battery: ~ 2 h 30

- **Characteristics of the mains power adapter:**

Input : 230 V - 50 Hz

Output : 12 V DC - 500 mA



The mains power socket used must be close to the charger/holder and easily accessible, so that it can be used as an "on/off" facility.

Transporting and protecting your telephone

Various models of carrying case are available. Ask your installation technician for information.

It is vital to use the special protective carrying case if your telephone is to be used in an industrial environment (presence of dust, filings, vapours of diverse origins and risk of being dropped).

Warranty

Independently of the legal warranty that covers this appliance, it is guaranteed for 1 year, parts and labour, counting from the date indicated on your invoice. Nevertheless, if the legal warranty in effect in your country exceeds 1 year, then the legal warranty is the sole warranty applicable.

The invoice will be demanded if making a claim under the warranty. The warranty does not however apply in the following cases: in the event of use that does not comply with the instructions given in this user's manual, faults or damage caused by natural wear, damage resulting from a cause external to the appliance (e.g. impact, fall, exposure to dampness, etc.), noncompliant installation or modifications or repairs carried out by people who are not approved by the manufacturer or retailer.

The CE marking indicates that this product complies with the following EC directives:



- 89/336/CEE (electromagnetic compatibility)
- 73/23/CEE (low voltage)
- 1999/5/CE (R&TTE)

Pursuant to directive 1999/5/CE (R&TTE) published in the Official Journal of the European Community of April 7, 1999, these items of equipment use the DECT harmonized frequency spectrum and can be used in all the countries of the European Community, in Switzerland and Norway.

No guarantee is given concerning possible interference affecting DECT equipment, due to other authorised utilisation of the radio frequencies concerned.

Declaration of conformity

We,

ALCATEL BUSINESS SYSTEMS

32, avenue Kléber

92707 Colombes Cedex - France

declare that the following products are deemed to comply with the requirements of Directive 1999/5/CE of the European Parliament and the Council.

ALCATEL Mobile 100 Reflexes

ALCATEL Mobile 200 Reflexes

ALCATEL Mobile 200 Ex Reflexes

Any unauthorized modification of the products makes this declaration of conformity null and void. A copy of the original of this declaration of conformity can be obtained by making a written request to:

ALCATEL BUSINESS SYSTEMS

Technical Services - Customer Care

1, rue du Dr. A. Schweitzer

F - 67408 Illkirch - France

**For further information,
visit our web site
www.alcatel.com**

Copyright © ALCATEL 2001. All rights reserved.

Alcatel Business Systems, in keeping with its policy of constant product improvement for the customer, reserves the right to modify product specifications without prior notice.

ALCATEL - 32, avenue Kléber, F-92707 Colombes Cedex
R.C. Paris 602 033 185

Ref. : 3BA 19602 ENAA Ed. 01



ARCHITECTS OF AN INTERNET WORLD